



Street light : GreenLine V3 – 90w



Puneet Kalia

Megha Soni

Trends in Road Lighting : Performance Price

External

An increasing level of social and environmental responsibility

- Stronger interest in 'Energy Saving Solutions
- Govt. recyclable subsidies & legislation at municipal level for energy saving & CO2 reduction

Improving 'quality of life' and 'well being' considerations

- Enhanced comfort, safety and security
- Not just light on the road but better uniformity and aesthetic lighting solutions
- Feeling of civic pride, belonging

Rapid urbanization; Economic expansion; GDP Growth; Increasing Wealth

- More roads as a result of rapid infrastructure development
- Upgrading city centers, residential areas, parks & squares

Product

Performance ask is getting stringent

1. higher lumen / watt
2. Lighting Parameter driven tender evaluation
3. Higher Surge Protection
4. Warranty Ask

Constant Price Erosion in Public tenders

1. Limited opportunities Post COVID
2. Growing number of lighting Player

Greenline V3 – 90w

Street Lighting solution for city Roads

- Energy Efficient – High Efficacy of **>120lm/w**
- High Color Consistency – **SDCM<5**
- *Uniform light Distribution – **Dedicated street light optics***
- *Driver meeting all stringent specifications –**Efficiency, THD<10%**.*
- *With 10KV Surge Protection- **Sustain Erratic power supply***



Introducing ... Streetlight range with New Optics



Greenline V3 is a state-of-the-art LED luminaire at a surprisingly affordable price. Building on the strengths of already tested technology, this range of luminaire is designed to provide a cost-effective solution to those looking to reduce energy costs.

Greenline V3 offers all the advantages of LED lighting, without the high cost associated with this technology.

The *Greenline V3* range is the perfect solution for replacing luminaires fitted with high-pressure sodium, metal halide and other HID lamps.

Applications



Suitable for wide variety of road and compound Lighting application

- Municipal Corporations of Tier B/C cities
- Urban development Authorities
- City Development Authorities
- Industrial Roads

Greenline V3

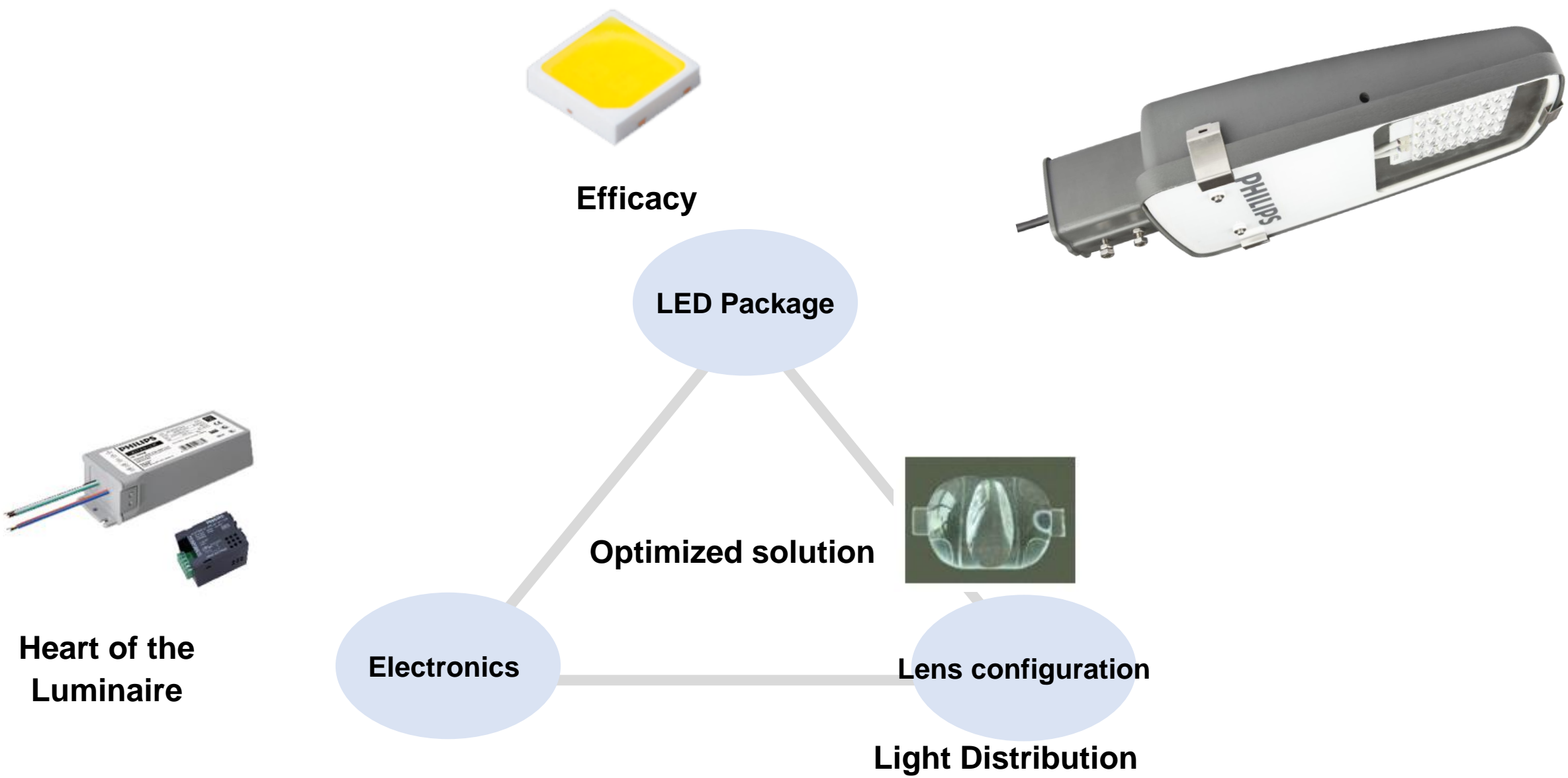

Greenline V3 Range

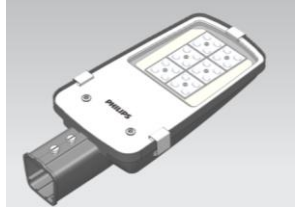

Housing made of high pressure Die cast Aluminium with low content of Copper
Finely machined with Aluminium extrusion clamps in low wattages.



Best in class LED's from leading LED supplier to ensure reliable quality and lifetime
Ensures consistency in colour.



Transparent and weather resistant grade Polycarbonate material for optical lenses. It can
withstand harsh weather conditions and resistant to UV and yellowing



BIS Approved Driver
440V Stress Voltage protection for 8 Hrs.
Auto shutdown at $\geq 325V$ and auto recovery
Auto shutdown at $t \leq 90V$ and auto recovery
Fully Potted & Encapsulated

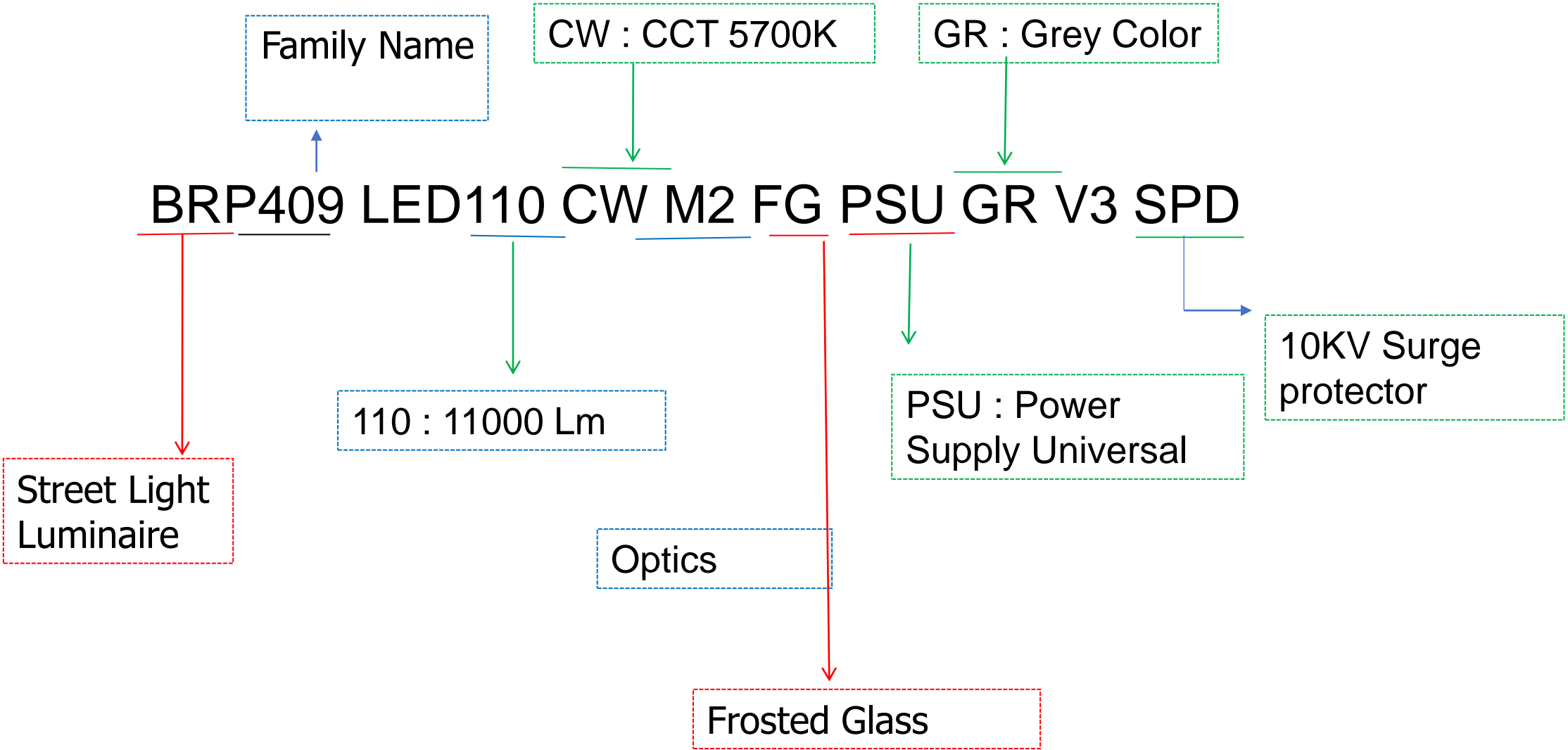

How to read the Cat ref

SPECIFICATION SHEET

*All the electrical and photometry parameters will have a variation of +/-10% as per IS

S No.	Description	BRP 409 V3
1	System Lumen	1100 Lm (Nominal)
2	CCT	5700K
3	CRI/ SDCM	70 , <5
4	Electrical Insulation	Class -1
5	IP/ IK	66 / 07
6	Serviceability	Class B
7	Mounting	Pole Dia. : 48mm to 60mm
8	Efficacy	120 Lm/W
9	Surge	4KV Internal and 10KV External
10	Driver	Fixed output
11	LED	High Power
12	Housing Material / Finishing	Pressure Die Cast Housing LM 6 Alloy/ Dual Optics
13	THD	≤10% (At Full Load)
14	Optical Covers	Optics with Glass Cover
15	Wattage	90W (Nominal)
16	Operating Voltage Range	140-270V (CLO)
17	Dimensions/Weight	L-458mm , W-203mm , H-94mm , 3 Kg(Nominal)

Dimensions

Type	Luminaire Dimension(mm)	Weight(kg)
BRP409 V3	L458xB203xH94	3 Kg

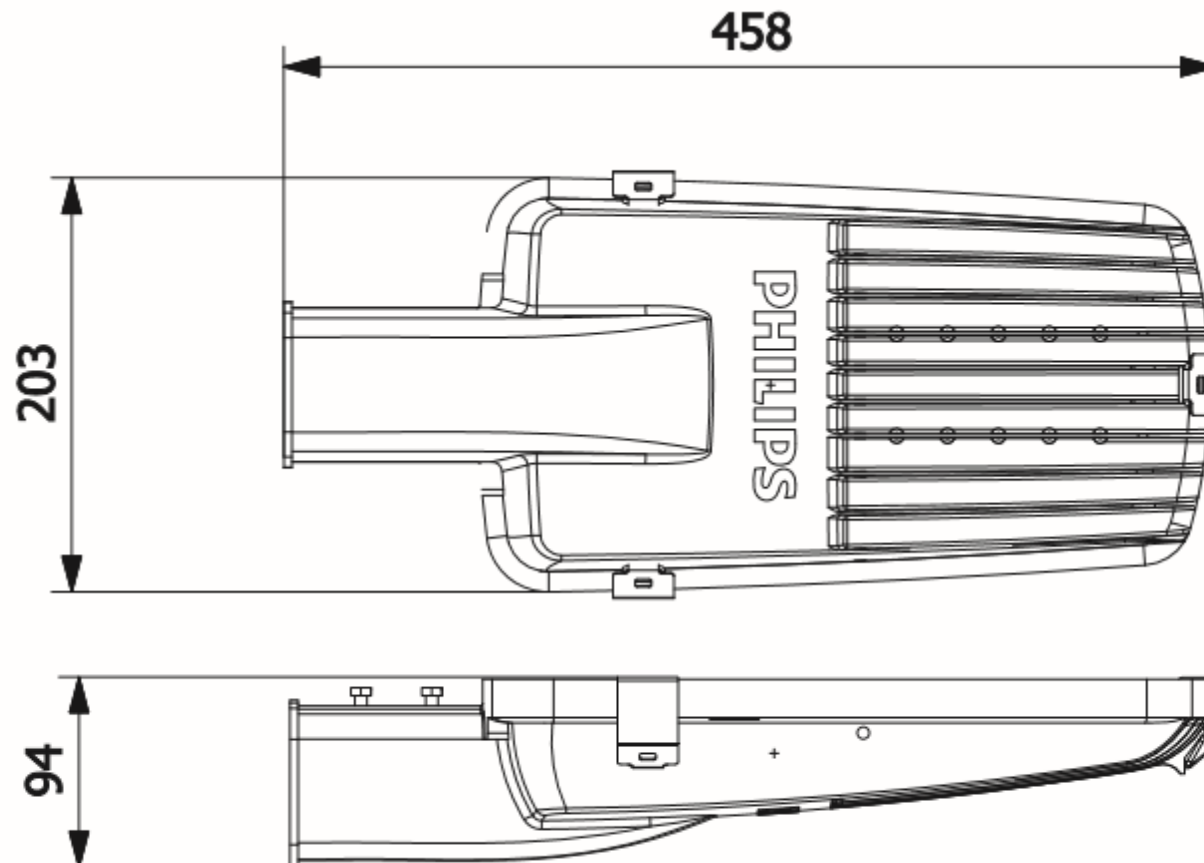
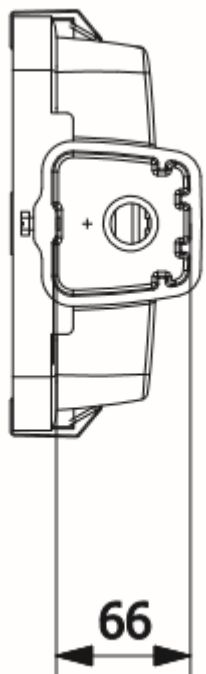

S No.	12 NC	Description	Qty per Box	Spare Driver 12 NC
1	919515814424	BRP409 LED110 CW M2 FG PSU GR V3	1	9290 021 65706
2	919515814425	BRP409 LED110 CW M2 FG PSU GR V3 SPD	1	9290 021 65706

Mounting Instructions

Dimensions

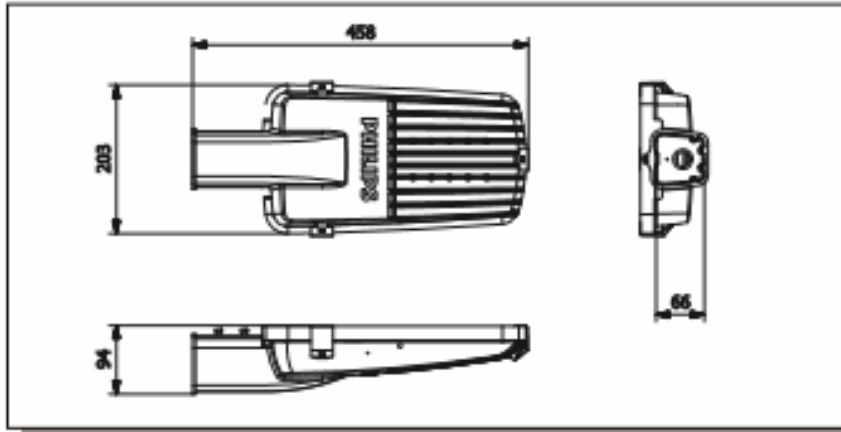

Installation

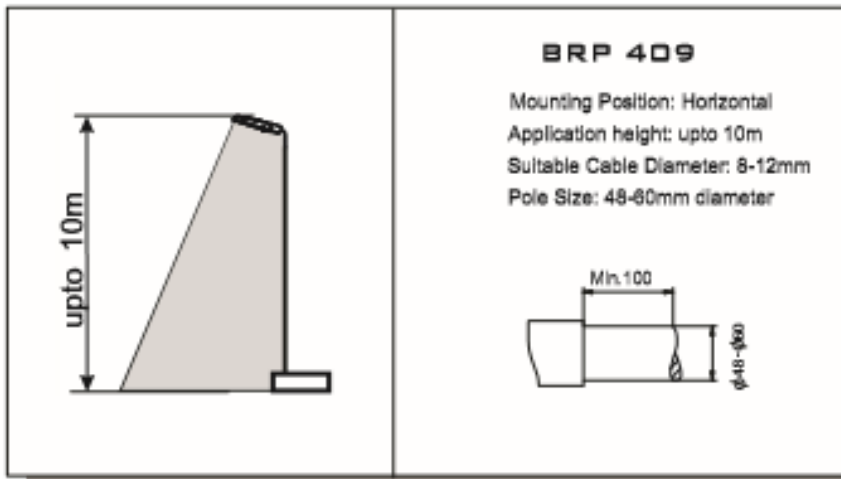

BRP 409

Street Lighting Luminaire

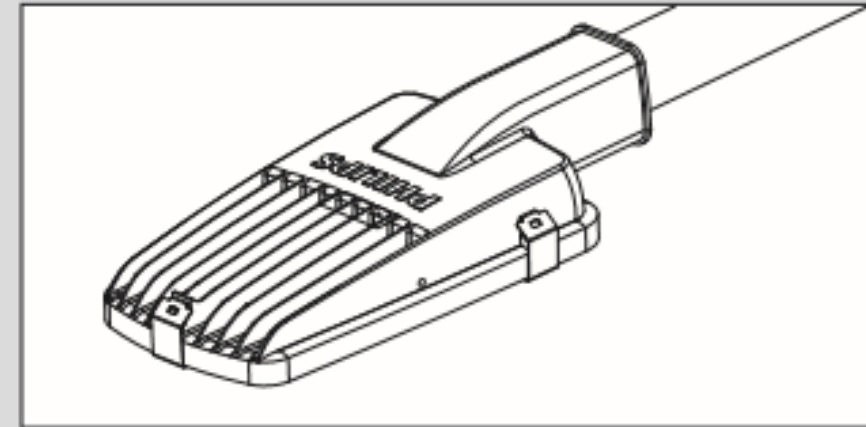

WATER TIGHT DESIGN

Type	:	BRP 409
Lamp	:	LED
Voltage	:	240 V, 50 Hz
IP Classification	:	IP 66
Net Weight	:	3.0kgs
Max. Projected Area	:	0.075 m ²
Application	:	Outdoor use only

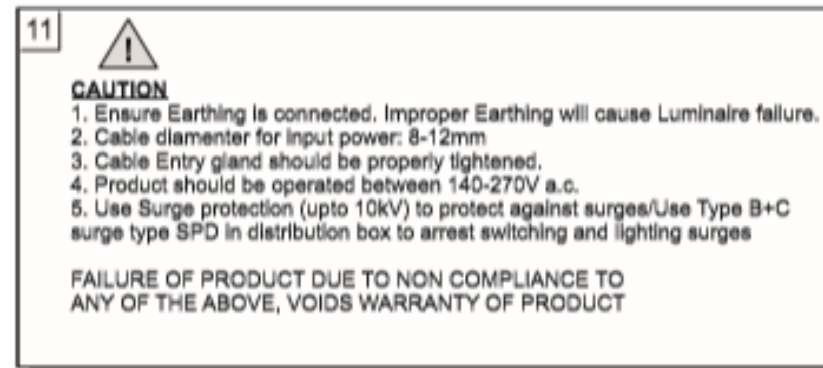
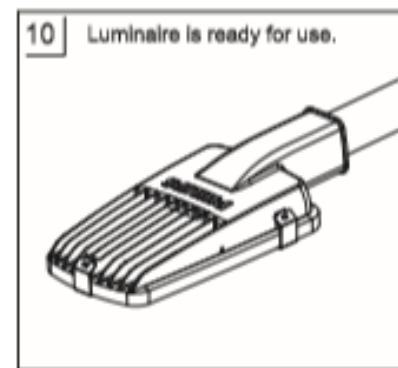
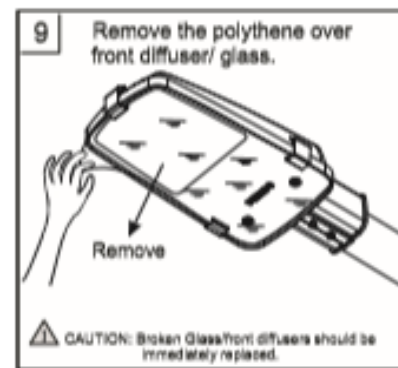
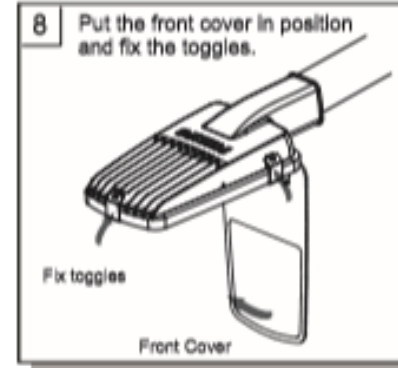
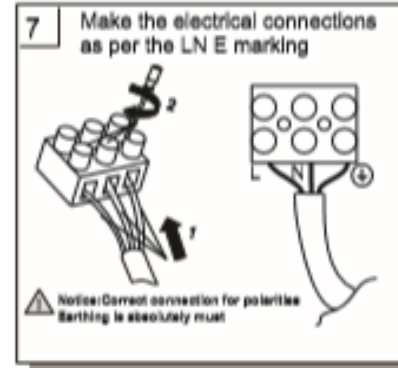
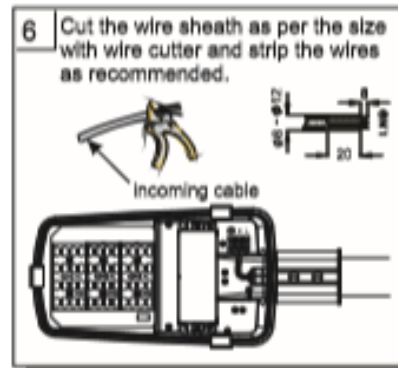
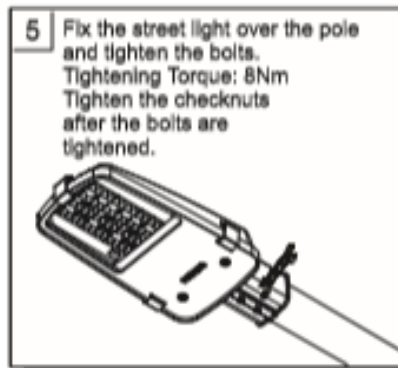
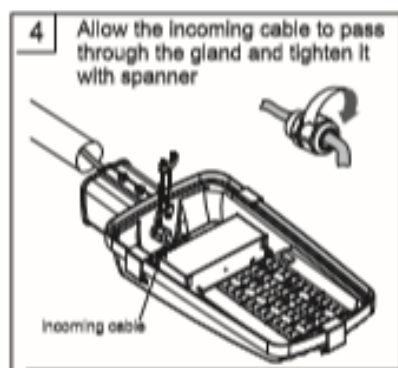
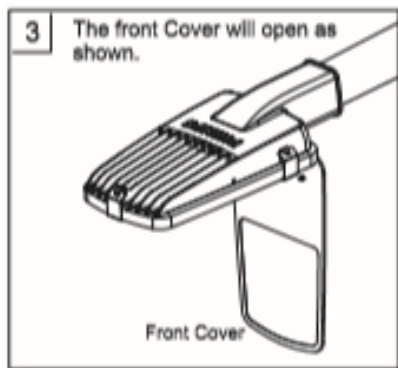
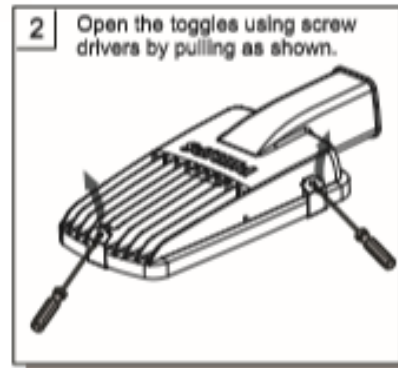
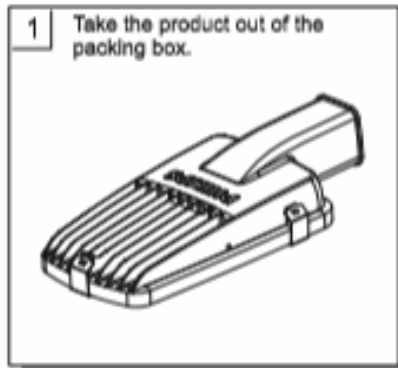

We listen to and understand your needs



Global presence
and local experience
delivering multi-tiered
support



One-stop shop:
solutions and services
across the lighting value
chain



World-class innovation
capabilities and deep
application and system
expertise



Proven record of
quality and reliability –
no unpleasant surprises

Signify